

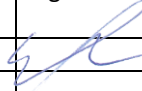

**P:** +63 45 499 3243  
**F:** +63 45 499 3243  
**M:** info@deltarov.com  
**W:** www.deltarov.com

Document Title: DROV-CON-FBR-001 REV3 Assembly guide  
Document Ref: DROV Manual Template.docx  
Owner: Managing Director

Rev#	Description	Prepared	Signature	Q/HSE Approved	Signature	MD Approved	Signature
1.0	Revision	EDE				EDE	

This document and the information contained herein is the property of Delta ROV Inc. No part of this document is to be reproduced or copied electronically or printed in any form without the prior approval of the Managing Director of Delta ROV Inc.

Document Title:	DROV-CON-FBR-001 REV3 Assembly guide
Document Ref:	DROV-AG-CON-FBR REV3.docx
Page Number:	Page <b>2</b> of <b>12</b>

**1. TABLE OF CONTENT**

---

**1. TABLE OF CONTENT ..... 2**

**2. PREPARING THE FIBRE ..... 3**

**3. ASSEMBLING THE CONNECTOR..... 6**

**4. ASSEMBLING THE BULKHEAD ..... 10**



## 2. PREPARING THE FIBRE

Both bulkhead and connector use a standard LC-SC/UPC SM fibre patch cord. The length required will vary depending on individual requirements. Our kit comes with a 2-meter lead as per below.



Cut the length you require from the SC side.



Remove the plastic cover from the fibre.



Using side cutters break off the blue shell



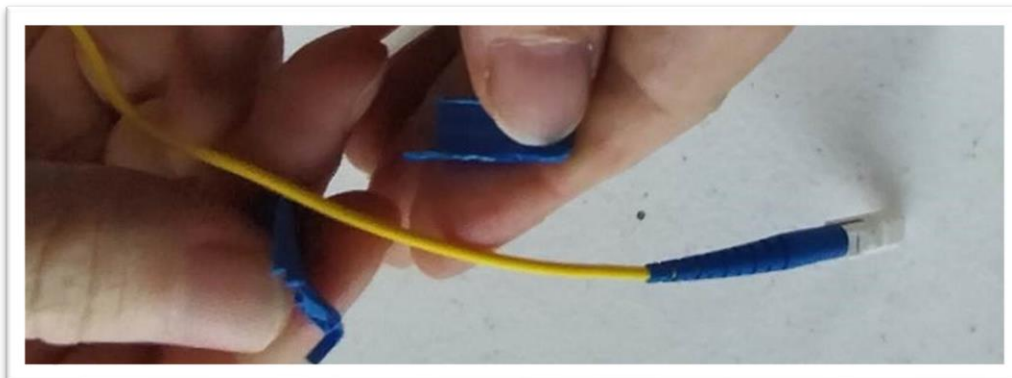

Remove the white clip using side cutters.

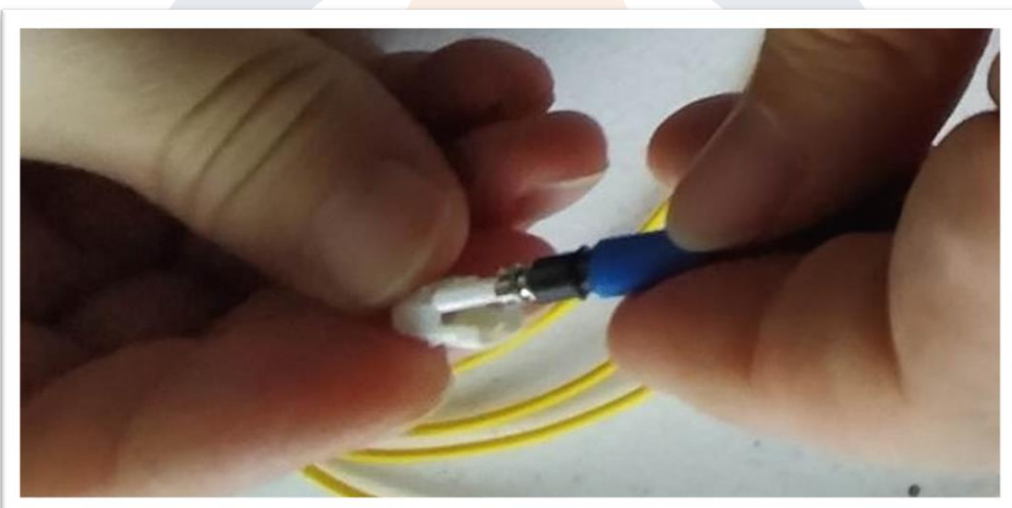

Pull the fibre from the yellow outer sheath.



Your fibre is now ready to be inserted into the bulkhead or connector.



### 3. ASSEMBLING THE CONNECTOR

Insert the fibre with spring in the back of the connector.

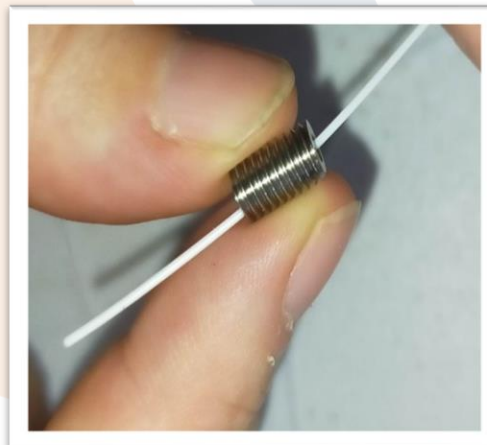
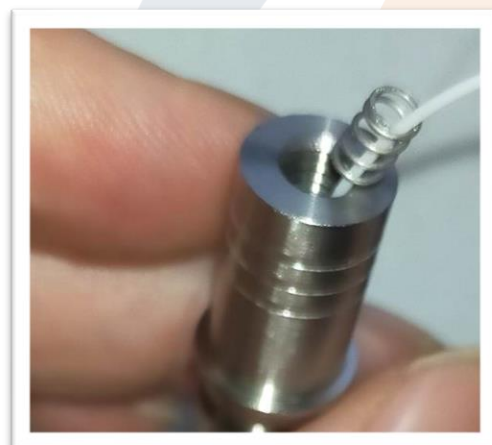

Insert the packing screw into the back of the connector using a flat screwdriver. Turn the connector, not the screwdriver. Be careful as this step can damage the fibre.

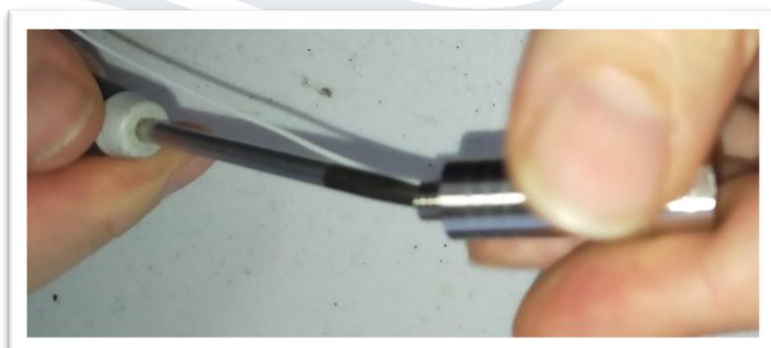

The packing nut should be far enough inside the connector to push the fibre and still allow the spring to compress.



Insert the ceramic ferrule inside the connector.



Insert the ferrule guide inside the connector and screw all the way down with the provided tool.

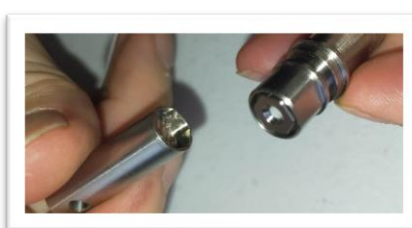
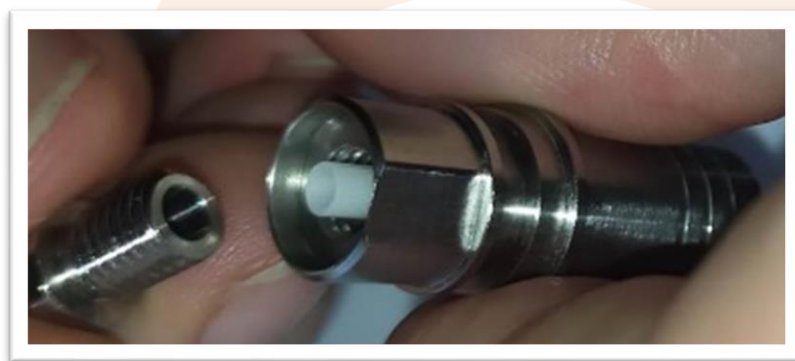

Pass the locking sleeve in the back of the connector.

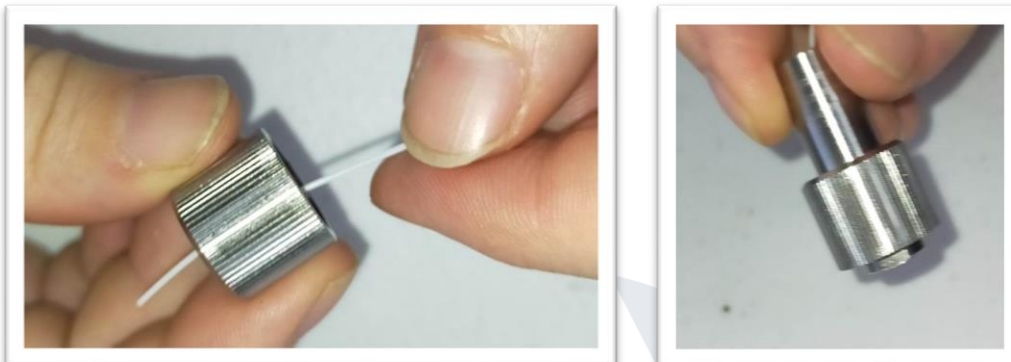

Pass the Wetlink body through the fiber and screw to the connector. Make sure the o-ring is present and greased.

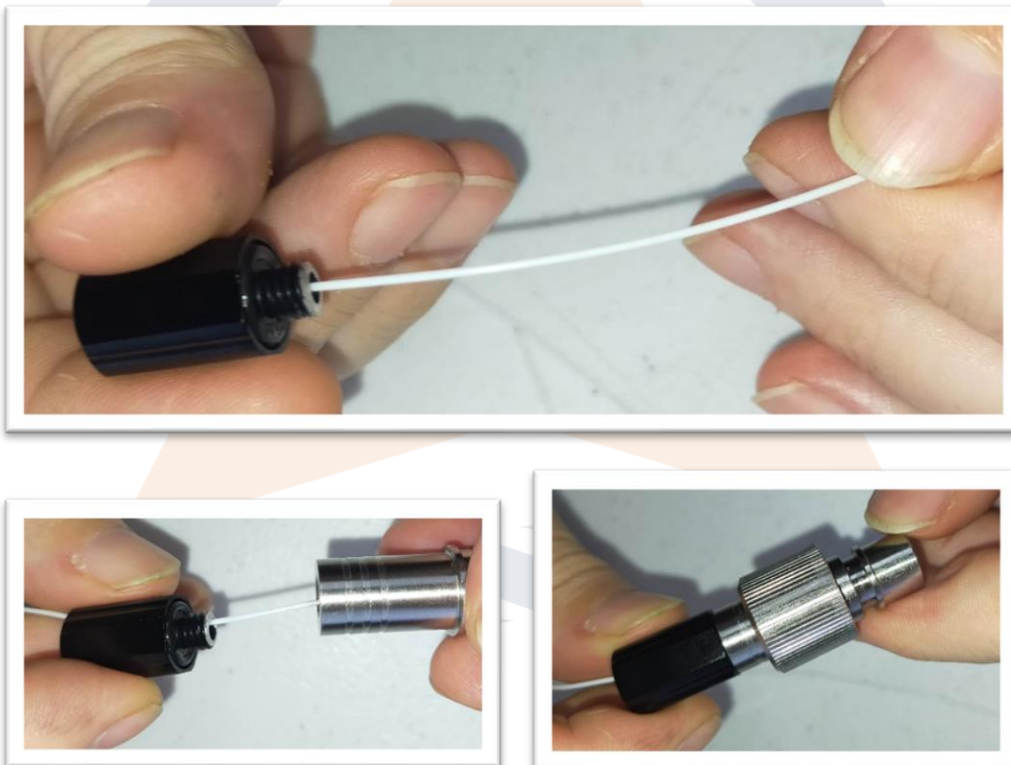

Insert the Wetlink gland and packing nut on the water-resistant sheath and fish the fibre through it.





Push the orange sheath until it bottoms out inside the Wetlink base.

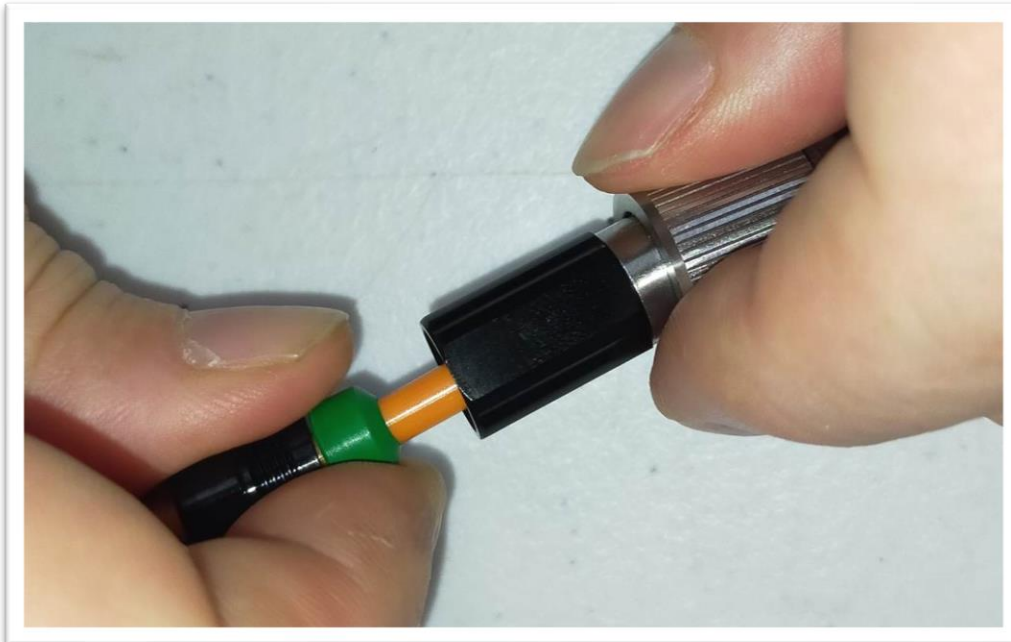

Screw the packing nut all the way until its fully inserted. Use spanners to ensure its fully secure. Failure to do so will result in possible water ingress.



The fibre connector is now fully assembled and ready to be spliced to your ROV tether. Don't forget to put the o-ring!



#### 4. ASSEMBLING THE BULKHEAD

---

Insert the fibre to the back of the bulkhead. No spring is used on this side.



Fish the packing screw on the fibre and insert in the back of the bulkhead.

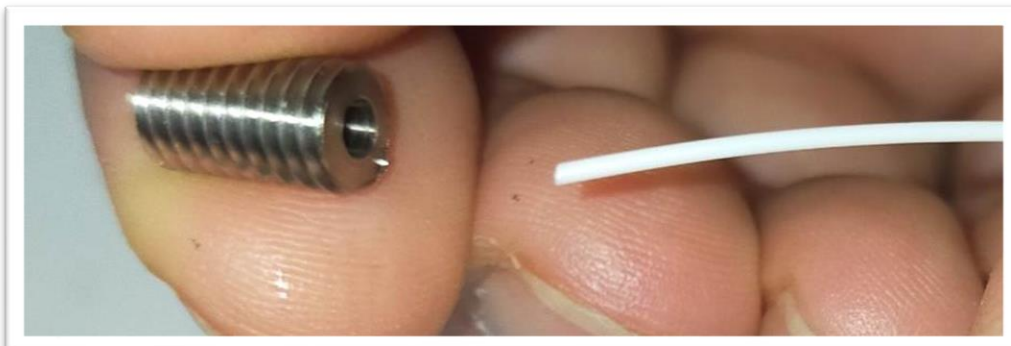



Insert the packing screw into the back of the bulkhead using a flat screwdriver. Turn the bulkhead, not the screwdriver. Be careful as this step can damage the fibre.



Retrieve the left-over outer sheath and pass the fibre through it. This will act as a bend stiffener and protect your fibre.



This final step is up to you. You can either use hot glue so you can reuse the bulkhead with a new fibre in case of failure. This method will not seal the bulkhead. Alternatively, you can pour epoxy to seal the bulkhead. This method will not allow you to reuse the bulkhead.

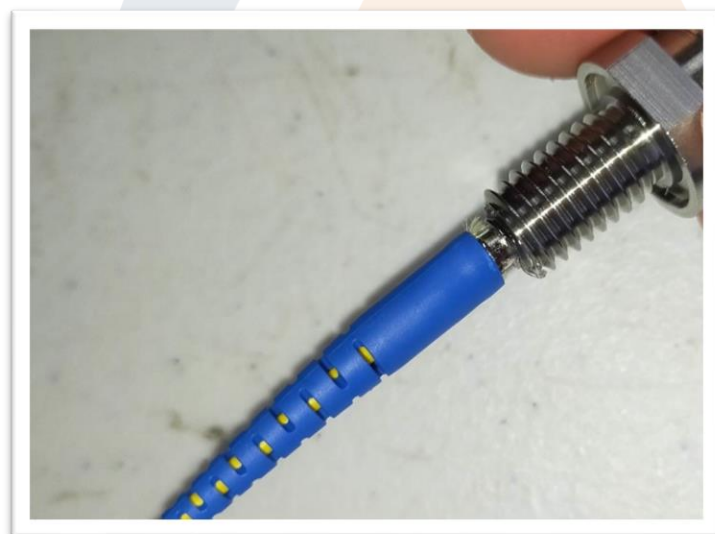
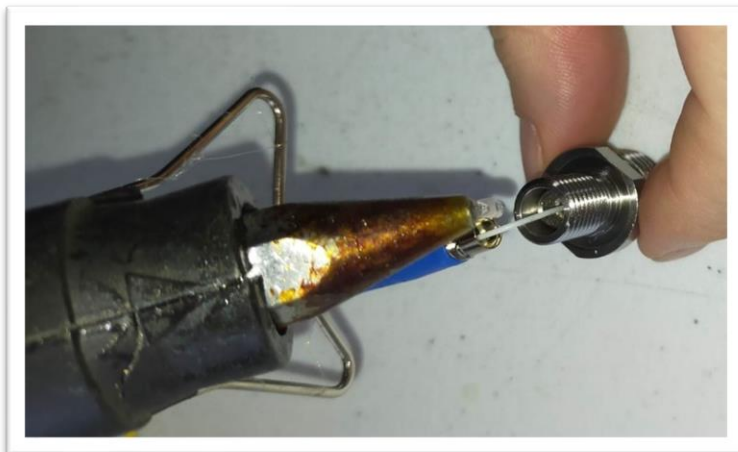

The fibre bulkhead is now fully assembled and ready to be spliced to a connector of your choice.

